

# Product data sheet peel-plate edge-bonded slotted shims

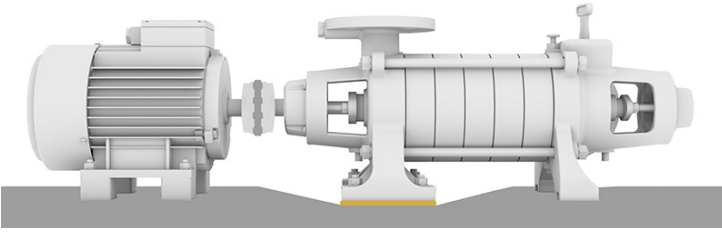

Standard edge-bonded slotted shims of the peel-plate brand offer great convenience in application. Unlike laminated shim stock, which is bonded across its entire surface, edge-bonded parts allow easy peeling of individual layers.

This minimizes the risk of injury, saves time, and allows the layers that are peeled to be reused.

Standard edge-bonded peel-plates are available in various sizes and designs immediately from stock. Foil thicknesses of edge-bonded standard-peel-plate are between 0.05 mm and 0.1 mm.

The total thickness of a standard sheet package is 1 mm. Parts that are between 0.05 and 0.1 mm thick are given different colours so that is easy to distinguish them from one another. Slotted shims of the peel-plate brand have rounded corners (radius = 6 mm).

## Standard

Item No.	Thickness (mm)	AxB (mm)	C (mm)
PP/00043	8 x 0,1 + 4 x 0,05	43 x 43	12
PP/00048		48 x 48	14
PP/00053		53 x 53	14
PP/00068		68 x 68	16
PP/00083		83 x 83	20
PP/00098		98 x 98	25
PP/00118		118 x 118	30
PP/00043/1	10 x 0,1	43 x 43	12
PP/00048/1		48 x 48	14
PP/00053/1		53 x 53	14
PP/00068/1		68 x 68	16
PP/00083/1		83 x 83	20
PP/00098/1		98 x 98	25
PP/00118/1		118 x 118	30

<b>Material</b>	stainless steel 1.4301 / 1.4310
-----------------	---------------------------------

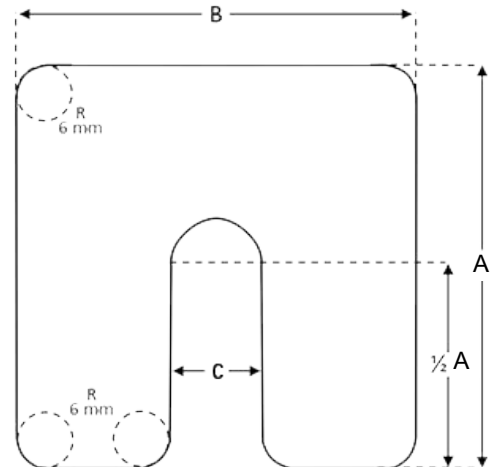

## Examples of custom designs

Item No.	Thickness (mm)	AxB (mm)	C (mm)
PP/00180	5 x 0,1 + 5 x 0,1	180 x 150	35
PP/00200		200 x 165	35
PP00240		240 x 200	35
PP/02222	20 x 0,1	200 x 200	35
PP/5300		250 x 250	50
PP/5300	5 x 0,1	180 x 150	40
PP/5310	8 x 0,1 + 4 x 0,05	225 x 225	45
PP/5310/51	1 x 0,5 + 5 x 0,1	225 x 225	45

